Removing the Carriage Assembly

Removal

1. Remove the encoder strip ▶ page 8-15.
2. Remove the right bracket ▶ 8-17.

In the following step, take care not to break the black plastic tab on top of the motor.

3. Press the carriage motor towards the left, and remove the belt from the motor shaft.

*If you need greater maneuverability of the motor, press the black plastic tab on the top **very slightly** downwards.*

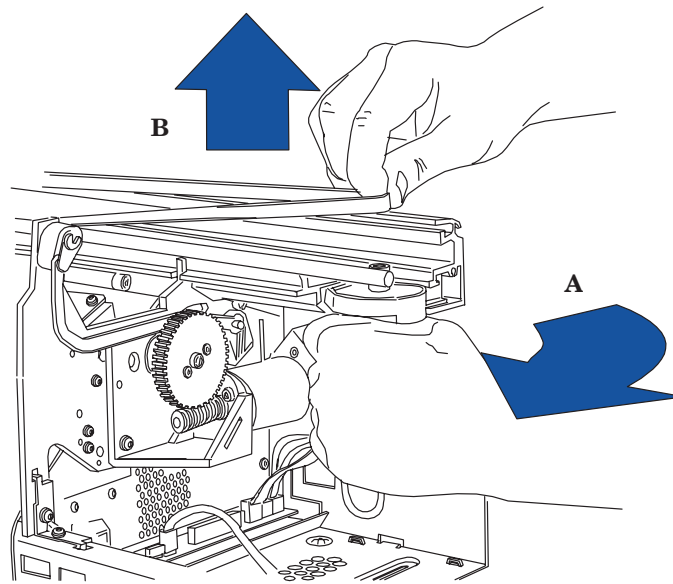

Reassembling: Make sure the belt is correctly positioned on the grooves of the shaft.

4. Rotate the motor on its hinge out towards the back of the Printer.

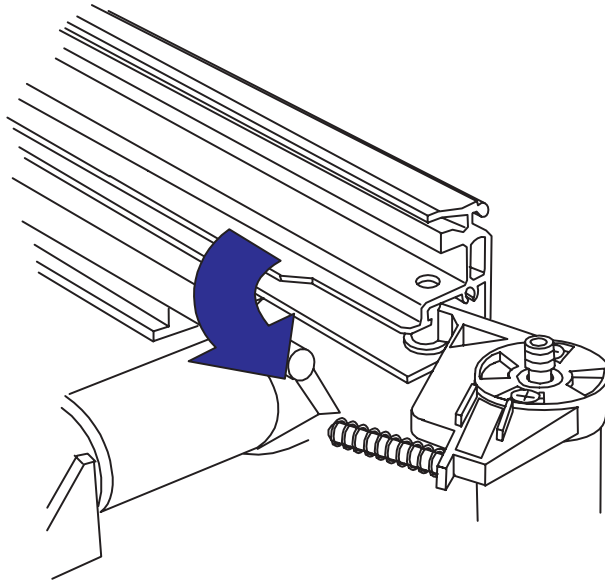

5. Release the belt from the pulley on the left of the Printer.

Reassembling: Make sure the belt is correctly positioned on the grooves of the pulley.

6. Release the two indicated clips on the top of the cartridge carriage by pulling them slightly outwards.

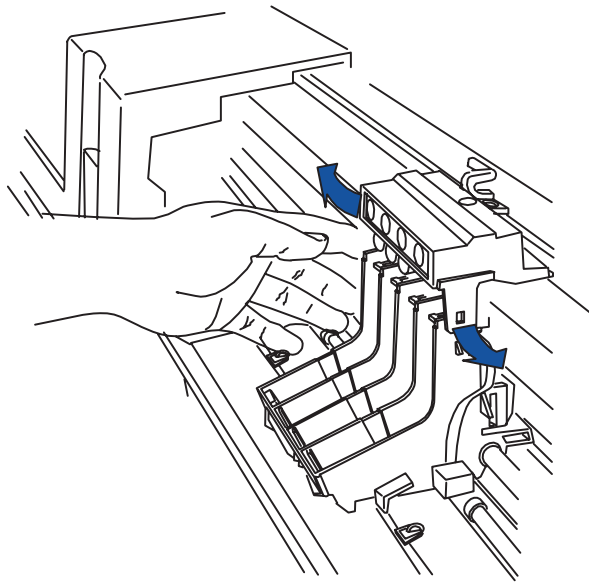

7. Pull the top of the carriage up.

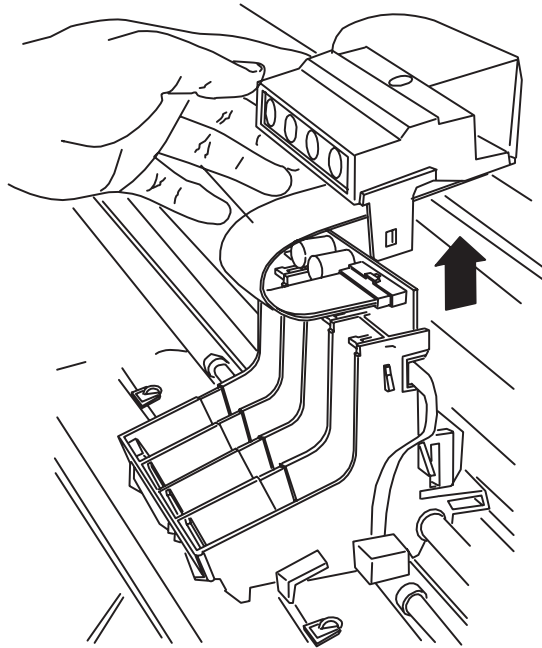

8. Disconnect the trailing cable from the connector on the carriage.

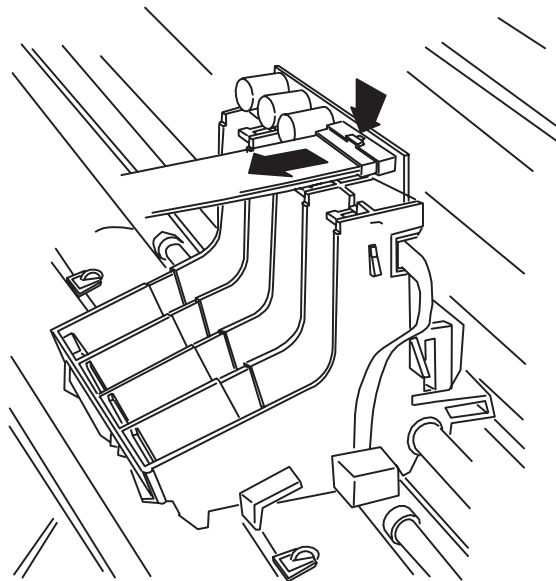

9. Rest the top of the carriage on the trailing-cable guide.

10. Slide the carriage to the right, and remove it with the belt from the Printer.

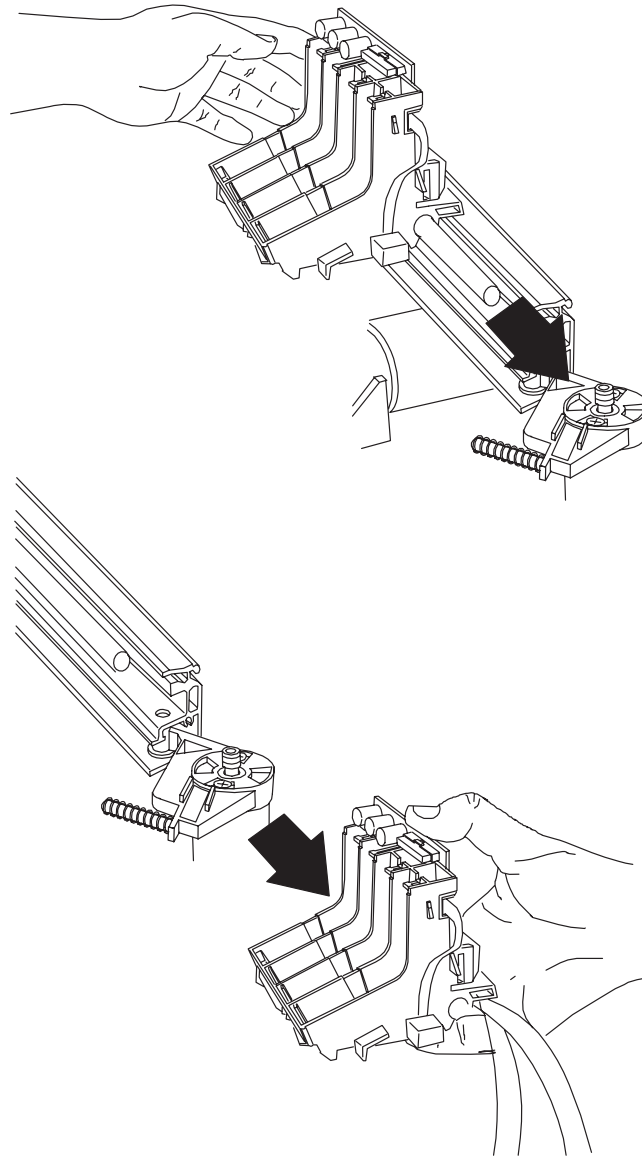

Reassembling: Position the belt **under** the back extrusion of the carriage.

Make sure that you correctly reconnect the trailing cable ▶ page 8-8.

After reassembling, make sure that you check the carriage-to-media distance ▶ page 5-5.

Calibration: After having reassembled the Printer, perform the black cartridge-alignment. (Details ▶ User's Guide.)

Removing the Drive Belt

Removal

1. Remove the Carriage Assembly ▶ page 8-37.

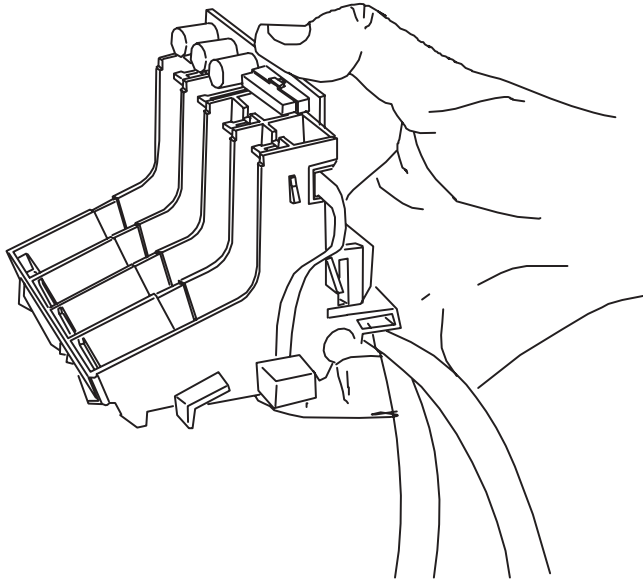

2. Release the belt from the clips on the underside of the carriage.

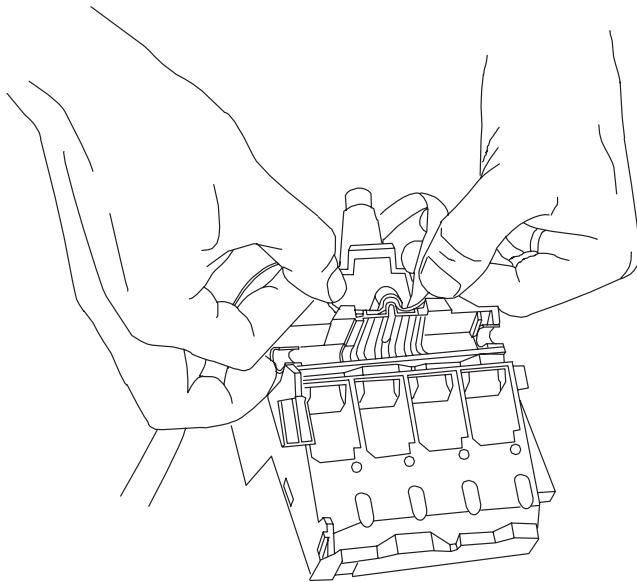

Reassembling: Clip the belt to the carriage, using the same part of the belt as was originally used. Also, match the vertical lines on the belt with the vertical grooves on the carriage. The horizontal lines on the belt face outwards.

Removing the Drive-Belt Pulley

Removal

1. Remove the encoder strip ▶ page 8-15.

In the following step, take care not to break the black plastic tab on top of the motor.

2. Press the carriage motor towards the left, and remove the belt from the motor shaft.

*If you need greater maneuverability of the motor, press the black plastic tab on top **very slightly** downwards.*

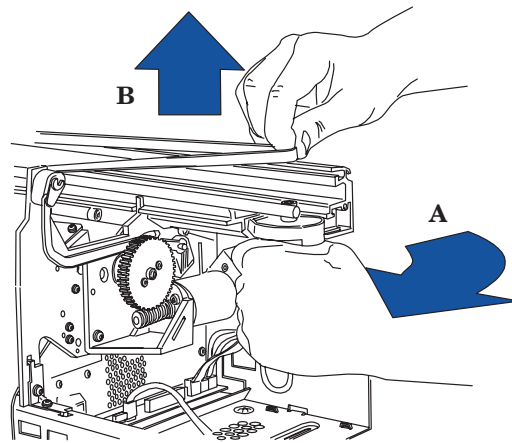

Reassembling: *Make sure the belt is correctly positioned on the shaft grooves.*

3. On the left of the Printer, remove the belt from the pulley.

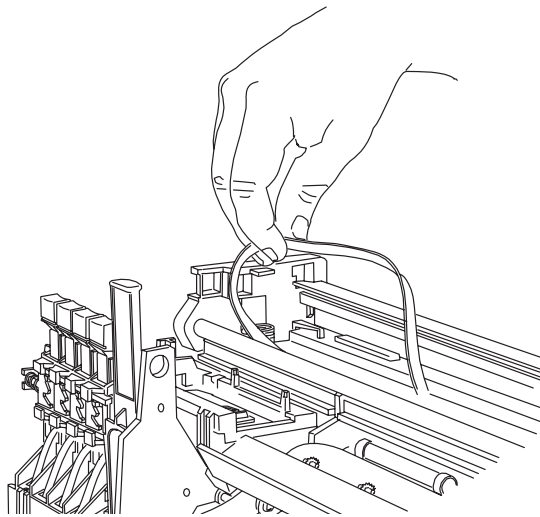

Reassembling: Make sure the belt is correctly positioned on the pulley grooves.

4. Underneath the left side of the chassis beam, release the black plastic clip and push the pulley shaft upwards.
5. Remove the pulley, shaft, and bushing from the Printer.

